



MixTec Heavy Duty Professional Blender

User's Manual

CONTENTS



BLENDER COMPONENTS	1
MODELS AND SPECIFICATION	1
IMPORTANT SAFEGUARDS	2
OPERATING INSTRUCTIONS	6
CLEANING & MAINTENANCE	9
TROUBLESHOOTING	9
PACKING CONTENT	9
SERVICE AND WARRANTY	9
WARRANTY CARD	10



Intertek
4001189

- Please read the instructions carefully before using your blender.
- Take good care of the manual for future reference.
- Technical specifications in this manual are subject to change without notice.

DECLARATION: We reserve the rights of explanation for any printing errors or omissions or any misunderstanding on content. If there is a technical improvement on our products, we will re-edit the manual without notice. If the product picture has any difference on appearance or colour, please contact your Distributor.

BLENDER COMPONENTS

SJ-9662



1	Tamper
2	Measuring Cup
3	Lid
4	Jar
5	Blades Assembly
6	Housing
7	Power Switch
8	High/Low Switch

SJ-9663

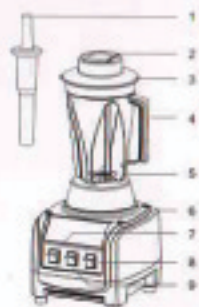

1	Tamper
2	Measuring Cup
3	Lid
4	Jar
5	Blades Assembly
6	Housing
7	Power Switch
8	Pulse Switch
9	High/Low Switch

SJ-9667
SJ-9668
SJ-9669



1	Tamper
2	Measuring Cup
3	Lid
4	Jar
5	Blades Assembly
6	Housing
7	Power Switch
8	Pulse Switch
9	Variable Speed

MODELS AND SPECIFICATION

MODEL	VOLTAGE	POWER	Max Speed	N.W
SJ-9662	120V/60Hz	1150W	26000RPM	5~5.5kg
SJ-9663		1250W	28000RPM	5~5.5kg
SJ-9667		1250W	28000RPM	5~5.5kg
SJ-9668		1390W	32000RPM	5~5.5kg
SJ-9669		1500W	38000RPM	5~5.5kg

IMPORTANT SAFEGUARDS

When using electrical appliances, Basic safety precautions should always be followed, including the following:

1. Read all instructions.
2. To protect against risk of electrical shock, do not put cord, plug, or base in water or other liquid.
3. Close supervision is necessary when any appliance is used by or near children.
4. Unplug cord from outlet when not in use, before putting on or taking of parts, and before blending.
5. Avoid any contact with blades or moveable parts.
6. Do not operate any appliance with a damaged cord or plug, or after appliance malfunctions, or is dropped or damaged in any manner. Call our customer service number for informations on examination, repair or electrical or mechanical adjustment.
7. The use of attachments, including canning jars, not recommended or sold by the appliance manufacturer may cause a risk of injury to persons.
8. Do not use outdoors.
9. Do not let cord hang over edge of table or counter, or touch hot surfaces, including the stove.
10. Keep hands and utensils out of jar while blending to reduce the risk of severe injury to persons or damage to the blender. A rubber spatula may be used but must be used by only when blender is not running.
11. Blades are sharp: handle carefully-especially when cleaning inside blender jar.
12. Do not use a broken, chipped or cracked blender jar.
13. Do not broken, cracked, or loose cutting blades.
14. Always operate blender with lid in place.
15. Do not blend hot liquids.
16. Do not use appliance for other than intended purpose.
17. Household use only.

SAVE THESE INSTRUCTIONS.

Safety Notes

To ensure safe use of the blender, this manual involves a variety of representation signs. If you do not follow the safeguards and misuse the product, problems or accidents may occur.

The meaning of signs:



Must (conduct)



Do Not (forbidden)



Notes and Warnings

CAUTION

After blending has finished, ensure all switches are in the "OFF" position before pouring the product.



This product is a Class 1 electrical product so please ensure it is properly plugged in to an earthed socket.



Do not put materials beyond the highest scale line on the blender jug. Make sure the lid is fitted tightly and then adjust the speed from Low to "High" gradually.

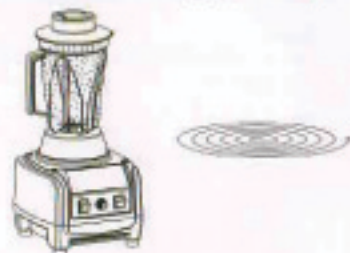

This blender is a high-powered product, please use the good quality socket. For your safety sake and avoiding fire disaster, never use bad socket or share one socket with other high-power electrical appliance (Air conditioner, Induction cooker and so on).



Never touch the transmission of the machine with any part of your body when blending. The blades are sharp so please take extra care when you clean or replace them.



Do not use broken or cracked blender jugs and check whether the transmission gear and blades are loose or broken before use.

**CAUTION**

Do not rinse the blender directly and never let water or liquid go inside the unit.



Never use the blender close to a hot appliance.



The blender should not be used by children or infirm persons. Care should be taken when used near these persons. Young children should be supervised to ensure that they do not play with the appliance.



Do not touch the control panel with sharp utensils because it may damage the control line inside and lead to a machine failure.



Please do not put the machine on a carpet, table cloth or paper because it may block the air inlet or outlet and then affect the cooling system inside.



Never operate the machine without the blender jug securely in place. To avoid transmission damage never run the machine with an empty blender jug.

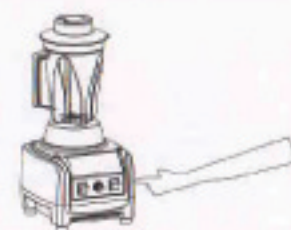

CAUTION

- ! Please keep the machine away from insects, dust and moisture. We suggest you clean the machine and pack it well in a plastic bag when not in use for long periods of time.



- ! DO NOT start blending hot liquids on HIGH speed. Always start processing hot liquids on LOW speed then increase while the machine is running to reduce the risk of spillage and injury.



- ! Please put the prepared ingredients into the jug, make sure the volume does not exceed the safe scale and then attach the lid tightly.



- ! Do not leave the blender unattended or leave contents in the container when not in operation.



- ! Please make sure the blender jug is placed on the machine securely and the lid is also securely fitted. Never open the lid during blending to avoid spillage.

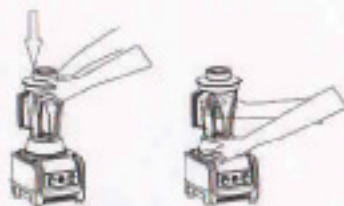

- ! Please take the plug out of the socket when you are not using the machine.



CAUTION

- ! In the back of the blender motor housing, there is a switch that can be pushed in for resetting the power supply if the motor has shut off caused by overload, this could prevent the motor from overheating.

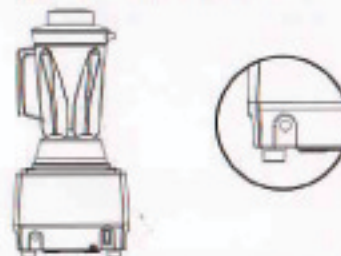

- ! The blender's motor has an overheat protector and if the motor gets too hot it will stop working automatically. If this occurs please take the plug out and allow the blender to cool down and then press the reset button at the rear right hand side of the machine.



- ! Do not operate any appliance with a damaged cord or plug. Return the appliance to your local Distributor for repair. Do not attempt to repair the machine.



- ! Put the machine on a level surface and keep a 20CM distance between a wall and the machine when in use. Never use the machine in a narrow space and never block the air inlet and outlet.

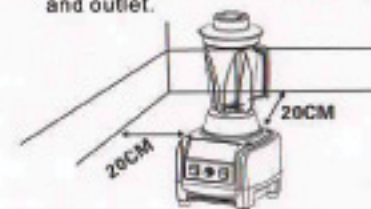

WARNING – This appliance should be used according to the instructions. MISUSE of this appliance will cause HAZARD.

OPERATING INSTRUCTIONS

Special notes

The main functions of this machine are for power-operated blending and mixing. It is suitable for the preparation of fruit smoothies, soups, fresh juices, sauces, milkshakes and other similar foods / drinks.

PREPARATION

1. Make sure the voltage is correct according to the plug label.
2. Make sure all switches are "OFF" or "ON".
3. Put the machine on a firm level surface and plug into the power source correctly.
4. Ensure the blender jug, lid, measuring cup and tamper are clean and prepare your ingredients before operation.

PLACING INGREDIENTS

1. Placing materials into the blender jug.
 - a) Place soft materials or liquids in first, then hard materials or ice in last. Large ingredients should be sliced or broken into chunks before being placed in the jug for better blending results.
 - b) Most ingredients should be started on a "LOW" speed then changed to "HIGH". If the ingredients get stuck you can press "PULSE" 2 to 3 times to refresh and then use the tamper to help blending.
2. Place the lid tightly on the blender jug.
3. Put the blender jug onto motor base correctly.

STARTING

1. Keep proper safe distance between people and machine when begin to operate.
2. Slow start: Depress the power switch to "ON" location, then machine start lowly then select the proper speed for blending by variable speed switch or LOW/ HIGH switch.
3. Pulse start: Depress the pulse switch to "ON", then machine run with max speed and other speed switches can not affected then. The pulse switch return back to "OFF" when release it. If you repeat press and release with a interval of 1 - 3 seconds, the machine will run with intermittent. Also accordingly you can choose the operation which mentioned in article 2.
4. Make sure all switches to "OFF" after finish blending, always waiting the machine to stop completely to take up the jar and pour out the mixture.

TIPS

1. Start the machine at low speed when blending hot liquids to avoid instant liquid spillage. Adjust to a proper speed once the blending is steady.
2. When ingredients get stuck or blending is hard, use the "PULSE" function to assist blending.
3. When blending tea or coffee drinks or something similar and you require foam, please start on "LOW" speed and according to the required amount of foam, you can select "PULSE" or choose a running time.

CONTROLLING

1. Time controlling

This machine can generally blend normal materials in 30S. If the results are not satisfactory, you can adjust the time to a maximum of 2 minutes.
2. Adding during operation

Never overfeed ingredients to avoid spillage and overloading

 - 1) Stop the machine from running.
 - 2) Wait for the blending to finish, then take off the measuring cup and add the proper ingredients through the feeding hole in the lid. (This operation should not be undertaken when making hot drinks. In that case you must stop the blender to avoid risk of hot spillages.)
3. Tamper usage

The tamper is generally used for blending some materials with low fluid content. When the materials do not flow or flow freely, you can press the "PULSE" function 2 to 3 times and then stir the materials with the tamper in all directions gradually.

CLEANING & MAINTENANCE INSTRUCTIONS

1. Always unplug the blender from the power source before cleaning.
2. Clean the machine and relative parts after use.
3. The outer case can be wiped with a damp cloth.
4. Clean the jug every time after use. Do not use abrasives or stiff brushes to clean the blender base or blender jug as this will make them dull or scratch them.
5. There will be some sediment attached to the blades after use. This will affect the blades so please ensure they are cleaned for optimum performance.
6. Make sure the machine is clean and dry before you store it away.
7. Please unplug the machine when not in use for long periods of time and keep the machine away from dust, insects and moisture.
8. DO NOT clean the blender jug and lid in a dishwasher.

TROUBLE SHOOTING

Problem	Possible cause	Solution
Blender fails to run	No power connection	Plug in correct power outlet
	Motor overheat protector was tripped	Allow motor to cool down with power off in a cool spot
Increased vibration and noise	The machine is not on a level surface	Place the machine on a level surface
	The blender jug has not been placed on the base completely	Make sure the blender jug is placed securely
	Container is too full	Decrease the ingredients
Leaking from lid	Water or liquid is too high	Decrease the water or liquid
	The lid is not fitted properly	Place the lid tightly on the blender jug

If the problem is still not resolved, please contact your local Distributor for maintenance

PACKING CONTENT

Motor Base	PC Jar	Lid	Measuring Cup	Tamper	Manual
1	1	1	1	1	1

SERVICE AND WARRANTY

1. If maintenance is required, you must return the machine to your local Distributor.

2. From the day of purchase, the warranty period is 12 months under the correct use. All rubbers, bearings, blades & jug assemblies are consumable parts and are not covered under the warranty.
3. Aftersales service will not be provided if non-original parts have been used.
4. During the warranty period, repairs will be charged under the following situations:
 - 1) Any damage or problem due to improper operation or usage not in accordance with the user manual.
 - 2) Any damage or problem due to dis-assembly and repair by alternative parties.
 - 3) Any damage or problem due to natural disasters.
 - 4) Liquid damage to the internal components of the unit.

WARRANTY CARD

Thank you for purchasing and using our professional blender in accordance with the warranty terms. Should a defect or problem occur due to faulty materials or manufacturing process within the warranty period, please return the machine to your local Distributor for repair. Carriage charges (collection and return) are not covered under the warranty.

Commodity name:	
Commodity model:	
Date of Purchase:	
Place of Purchase:	
Distributor stamp:	
Customer name:	
Customer address:	
Customer phone:	

Maintenance record

Repair date	Trouble situation	Maintenance station	Maintenance result